

DETAILING MANUAL

YKK 750 Compatible Shadow Box Panels

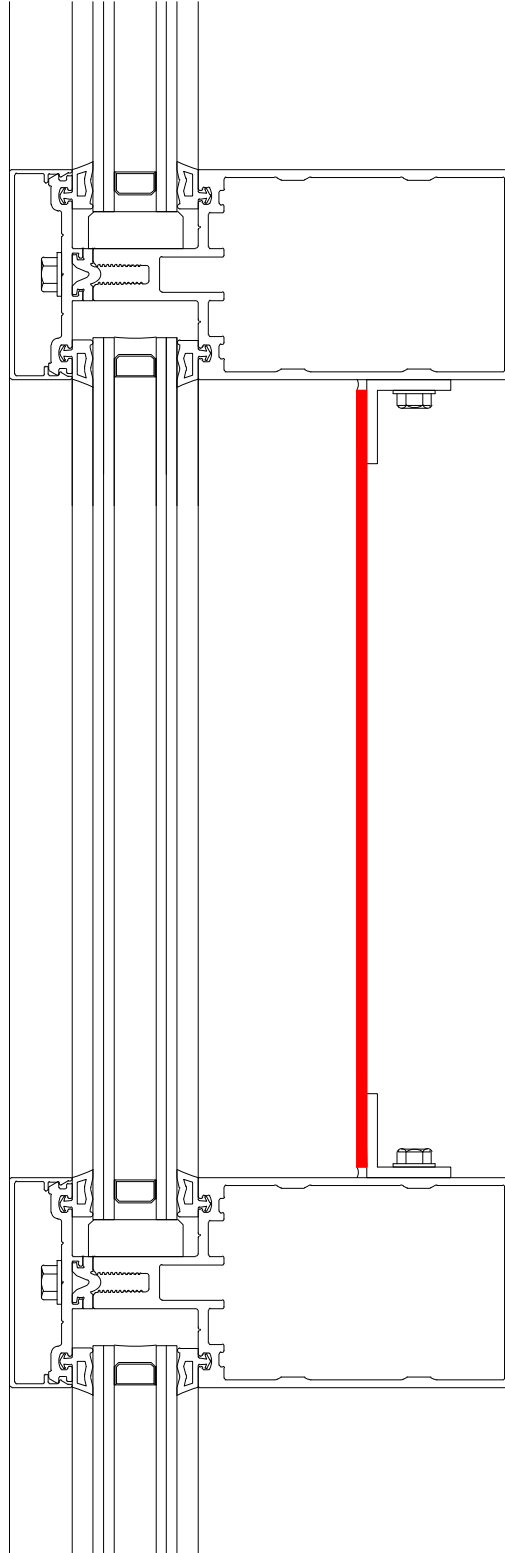

DETAILING MANUAL

YKK 750 Compatible Shadow Box Panels

Description

Bunting Architectural Metals shadow box panels create the appearance of depth behind a transparent lite of glass by incorporating a metal sheet into the curtain wall behind the lite. The metal sheet should be at least two inches behind the glass and painted to add the most visual depth to the wall. Insulation should also be installed behind the shadow box if interior finishes prevent room air from contacting this area. The system should be designed to collect any condensation that may collect on the exterior side of the metal sheet and drain it back to the exterior. Careful detailing can provide a method to thermally isolate the cavity from the interior. An interior back pan behind the insulation is desirable as well, to avoid condensation on the metal shadow box from the interior. Shadow box panels are secured to the curtain wall framing using appropriate fasteners and sealed to the framing by the installer. Shadow box panels are available in flat or formed configurations depending on the project specific mounting conditions.

Characteristics

Material: Aluminum 3003-H14

Material Thickness: 0.125" (1/8") Standard, Other Thicknesses Available

Pan Depth: Flat or 0.75" (3/4") Standard, Other Depths Available

Face Dimensions: Up to 5' x 10' In Any Increment

Oversize Face Dimensions: Up to 5' x 20' Available

Paint Finish: High Performance Fluoropolymer Finish

Note: Thermal performance and air/water proofing details are the responsibility of the project engineer. Bunting Architectural Metals does not control the selection of product configurations, materials, or hardware and assumes no responsibility therefore.

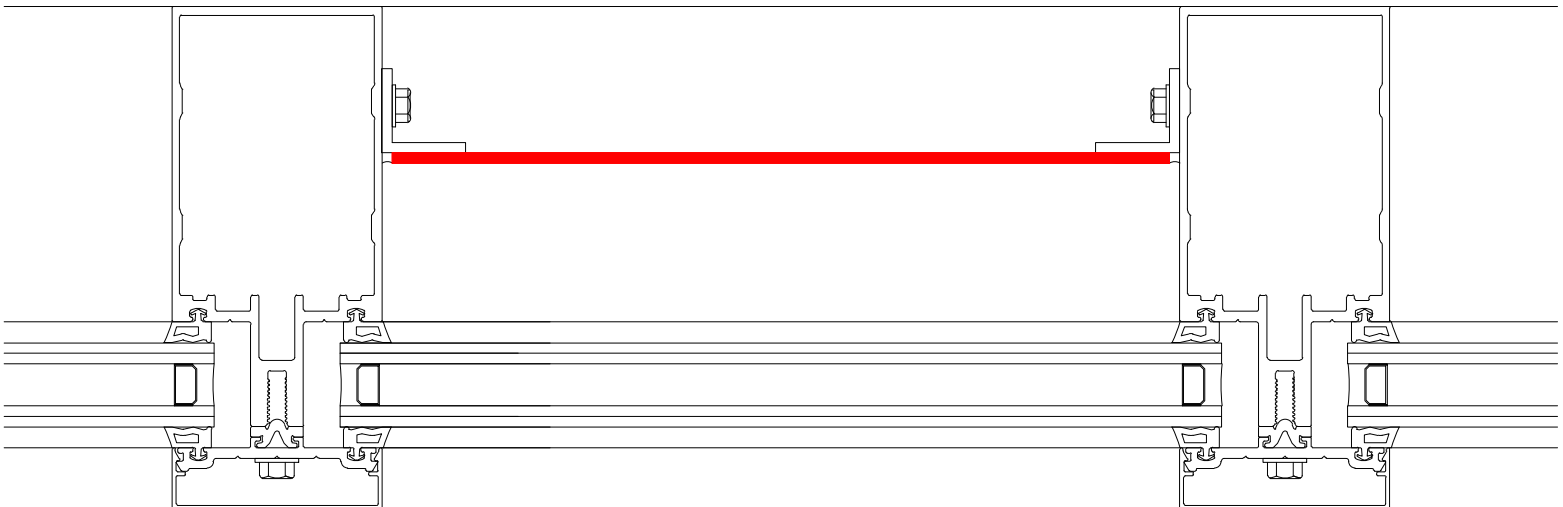

DETAILING MANUAL

YKK 750 Compatible Shadow Box Panels

Profiles

Bunting Architectural Metals Shadow Box Panels are available in two standard profiles shown below. Other profiles and shapes are available to meet project specific requirements



Flat To Mounting Angle

Flat To Back Pan

Formed

