

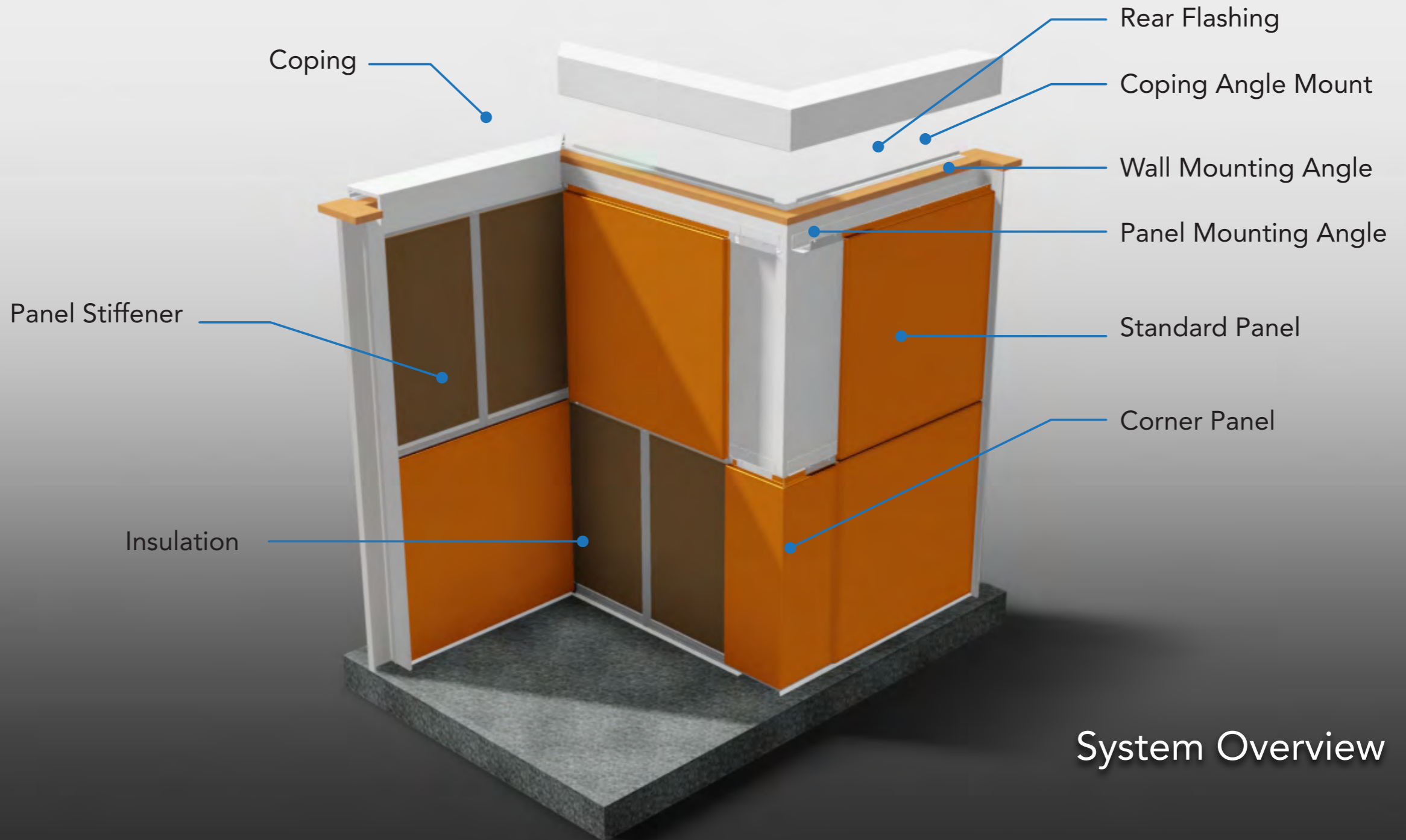

Installation Guide



System Overview



Step 1

Install Sill Flashing at bottom of wall. Work from left to right for best results.



Step 2

Install wall angles to sill flashing using ANSI B18.6.4 - 12-14 - 1.5 fasteners.



Bottom of wall angle is mounted 2" above the flashing.

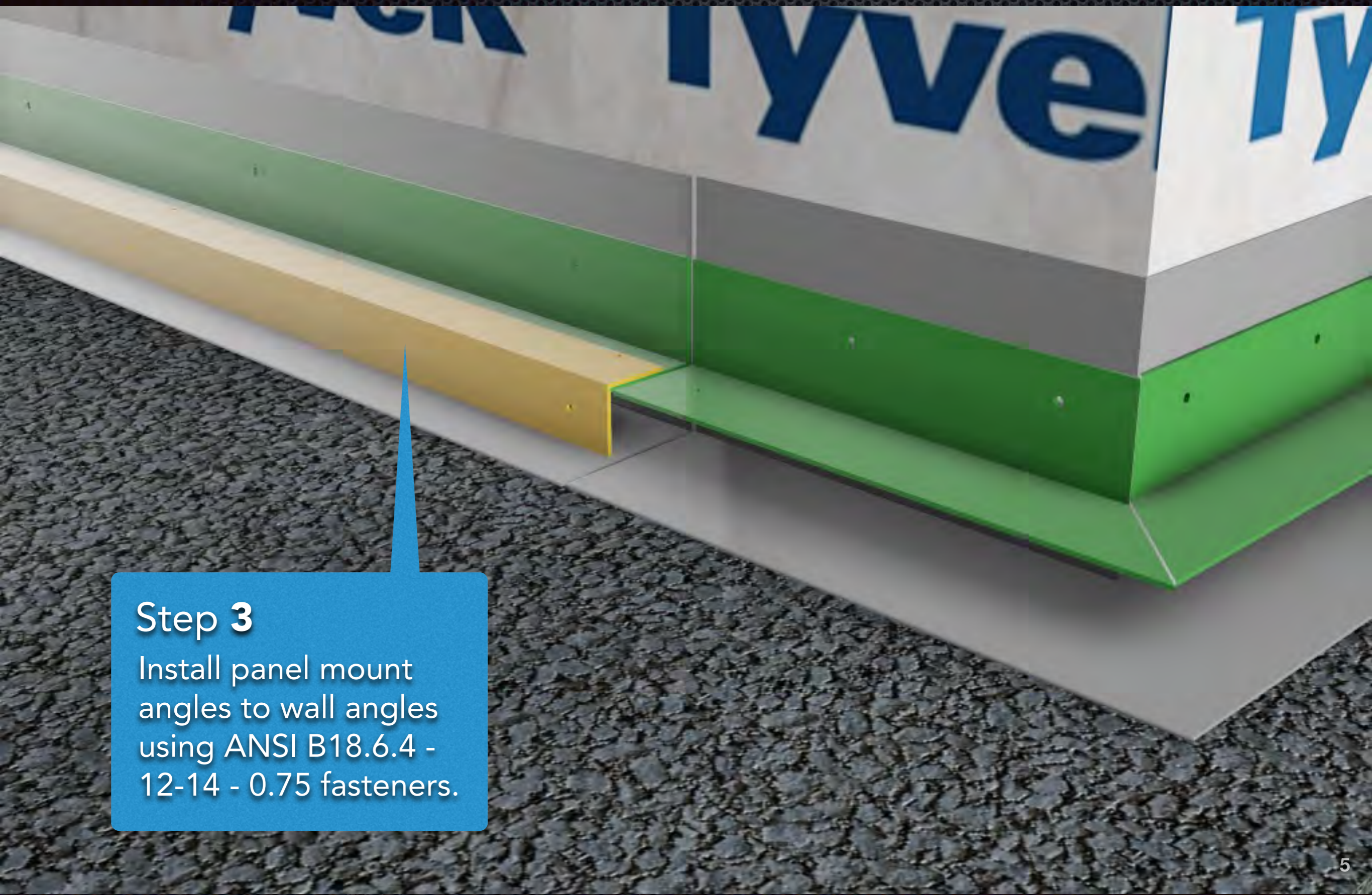

Step 3

Install panel mount angles to wall angles using ANSI B18.6.4 - 12-14 - 0.75 fasteners.



Step 4

Install panel catch to panel mount angles using ANSI B18.6.4 - 12-14 - 0.75 fasteners.

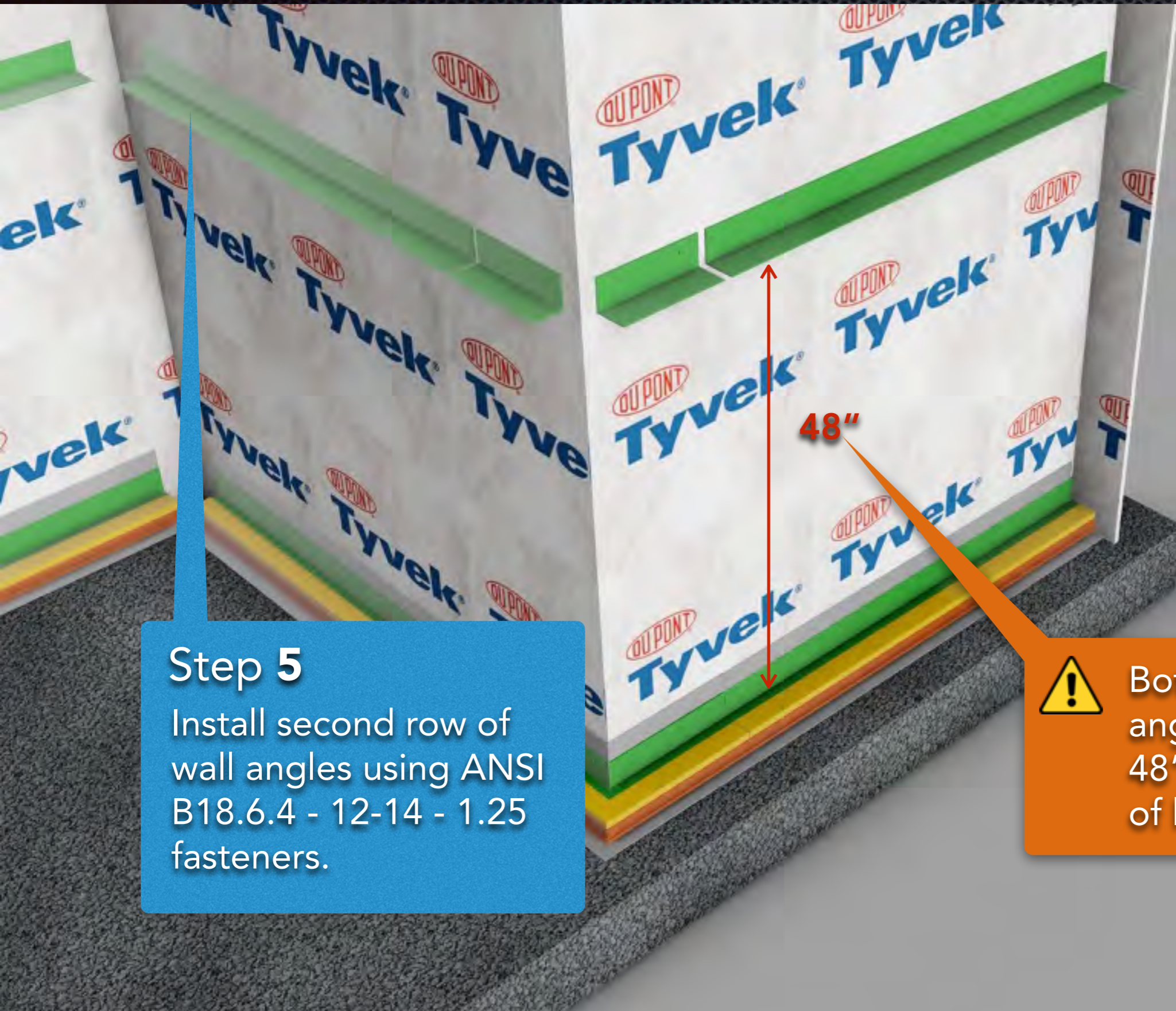

Step 5

Install second row of wall angles using ANSI B18.6.4 - 12-14 - 1.25 fasteners.



Bottom of upper wall angle is mounted 48" above the base of lower wall angle.



Step 5

Install insulation, working from left to right.



Step 5

Install insulation, working from left to right.

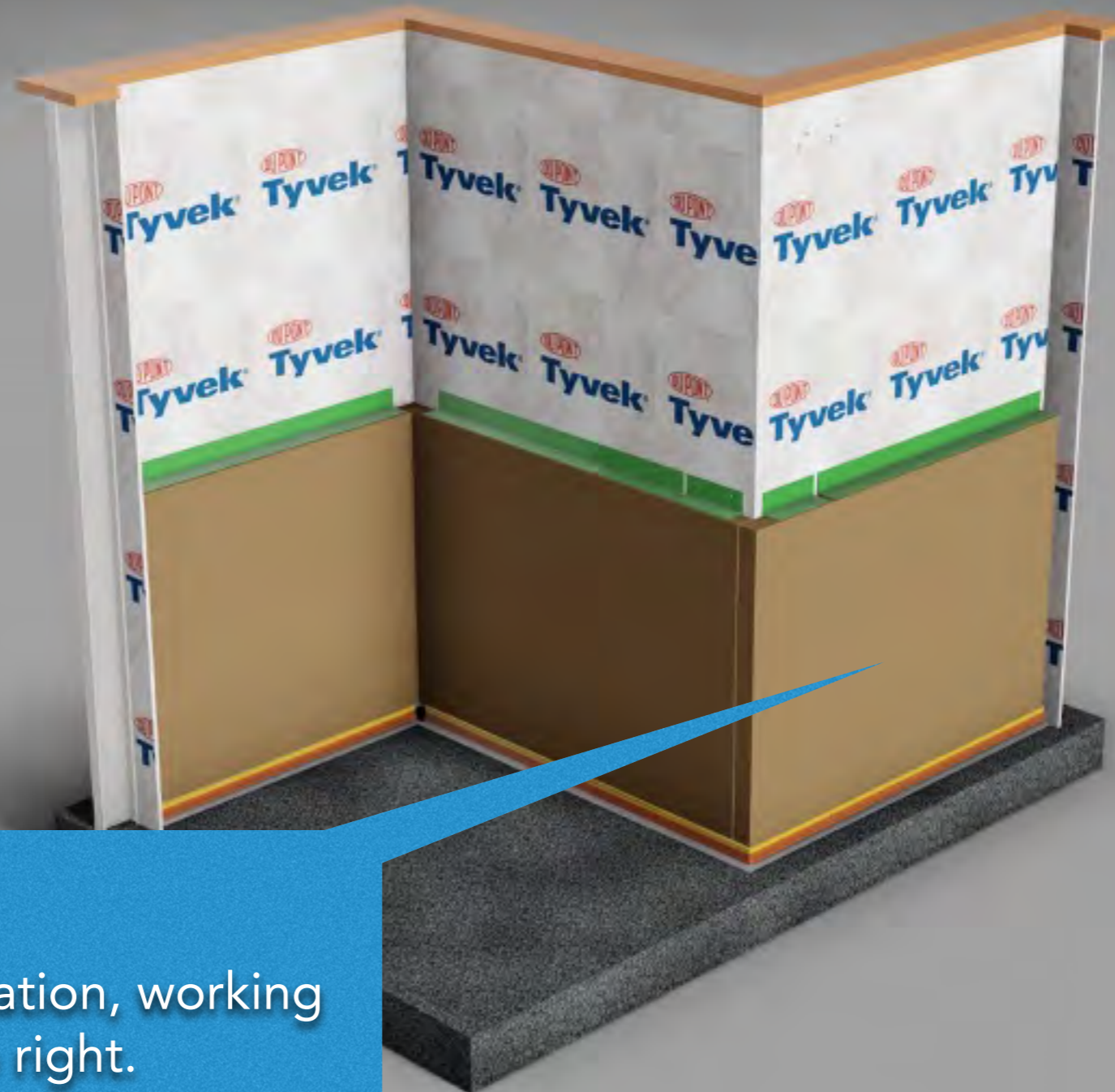

Step 5

Install insulation, working from left to right.



Step 6

Install first panel, starting on lower left of building



Step 6

Panel Assembly attaches to wall mount angle using ANSI B18.6.4 - 12-14 - 0.75 fasteners.



Step 7

Continue to install panel assemblies, working from left to right.



Step 7

Continue to install panel assemblies, working from left to right.



Step 7

Continue to install panel assemblies, working from left to right.

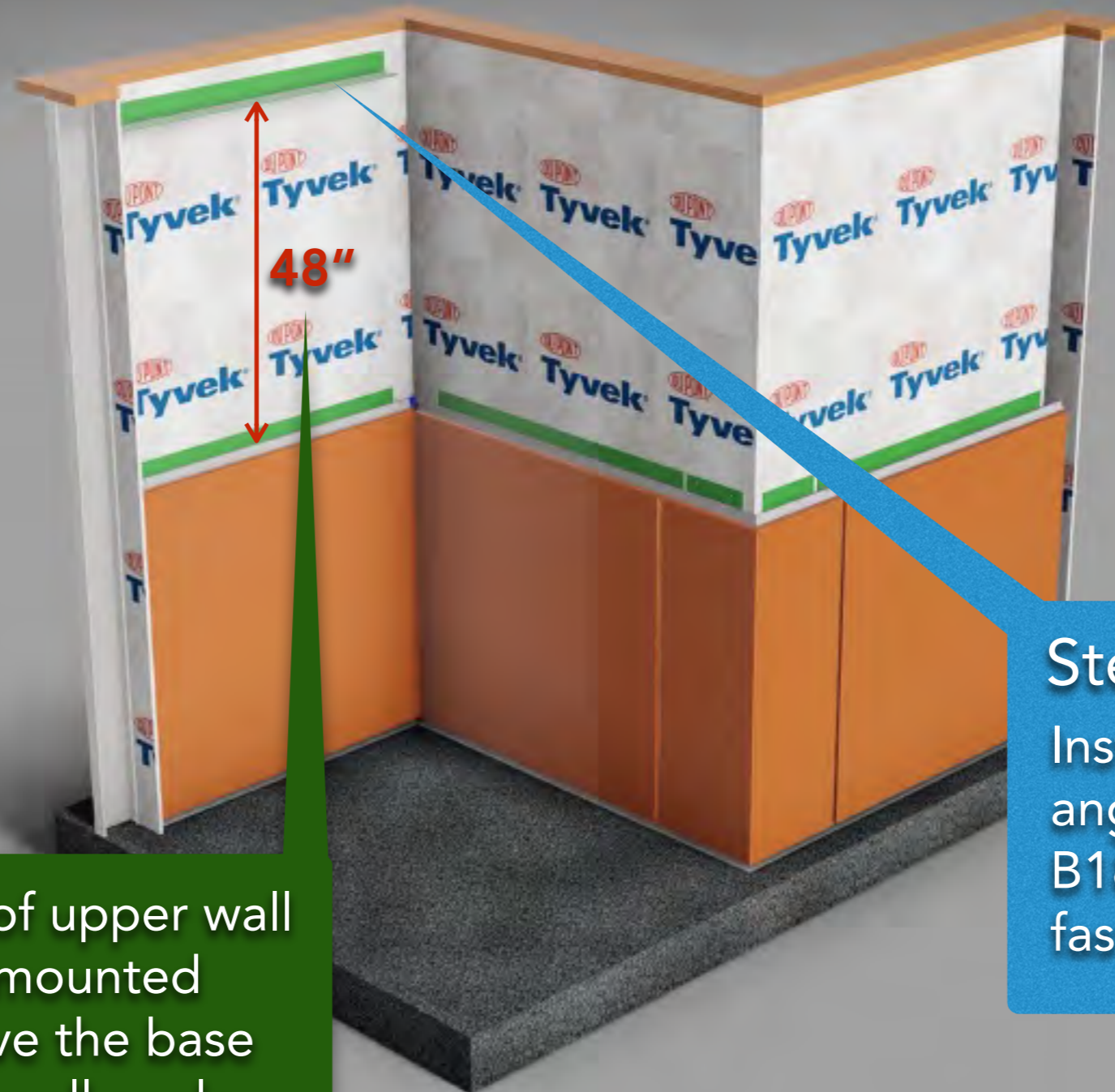

Step 8

Install next row of wall angles using ANSI B18.6.4 - 12-14 - 1.25 fasteners.



Bottom of upper wall angle is mounted 48" above the base of lower wall angle.



Step 8

Install next row of wall angles using ANSI B18.6.4 - 12-14 - 1.25 fasteners.



Step 8
Install next row of wall angles using ANSI B18.6.4 - 12-14 - 1.25 fasteners.



Step 8
Install next row of wall angles using ANSI B18.6.4 - 12-14 - 1.25 fasteners.



Step 9

Install insulation, working from left to right.



Step 9

Install insulation, working from left to right.

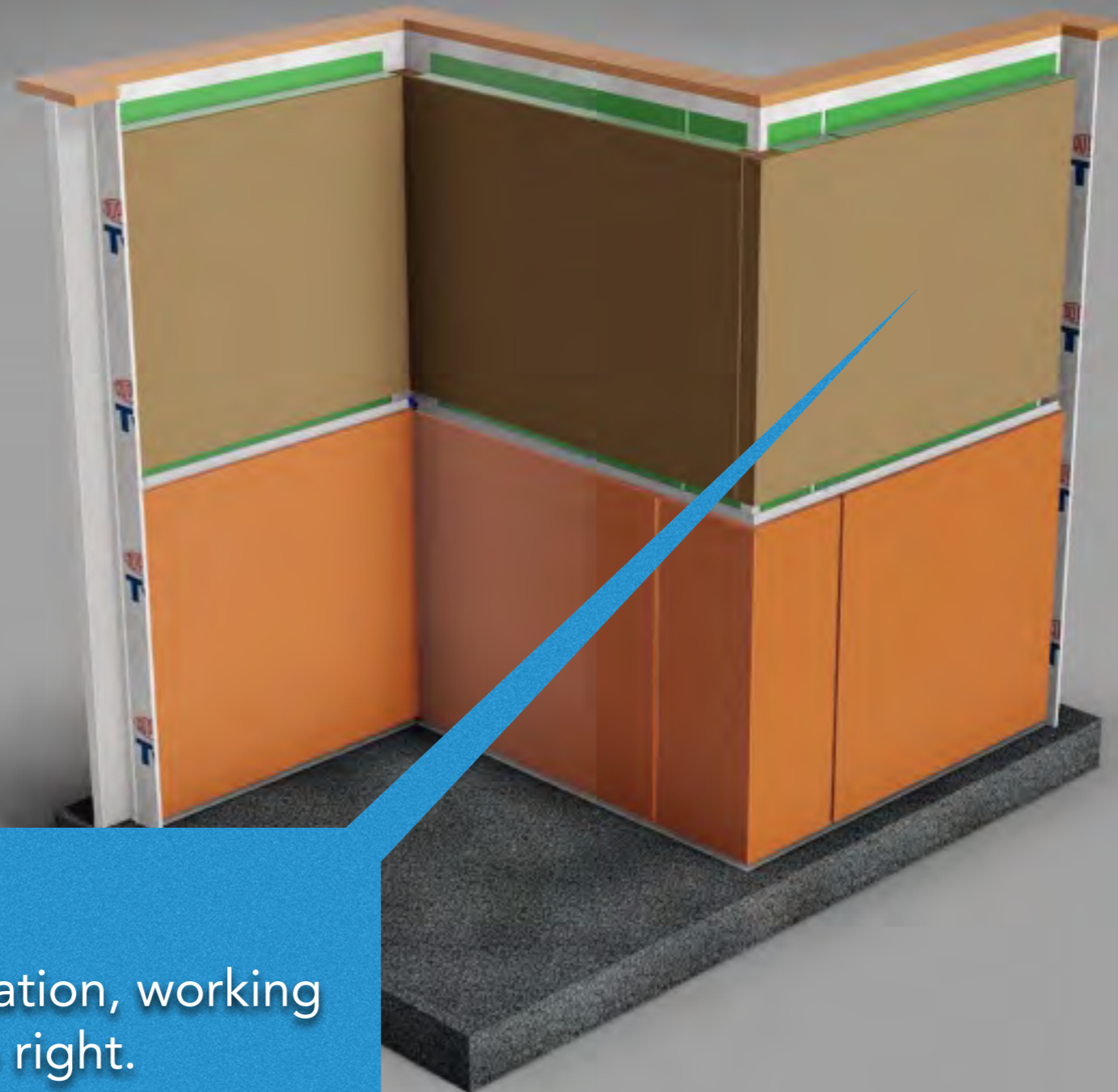

Step 9

Install insulation, working from left to right.

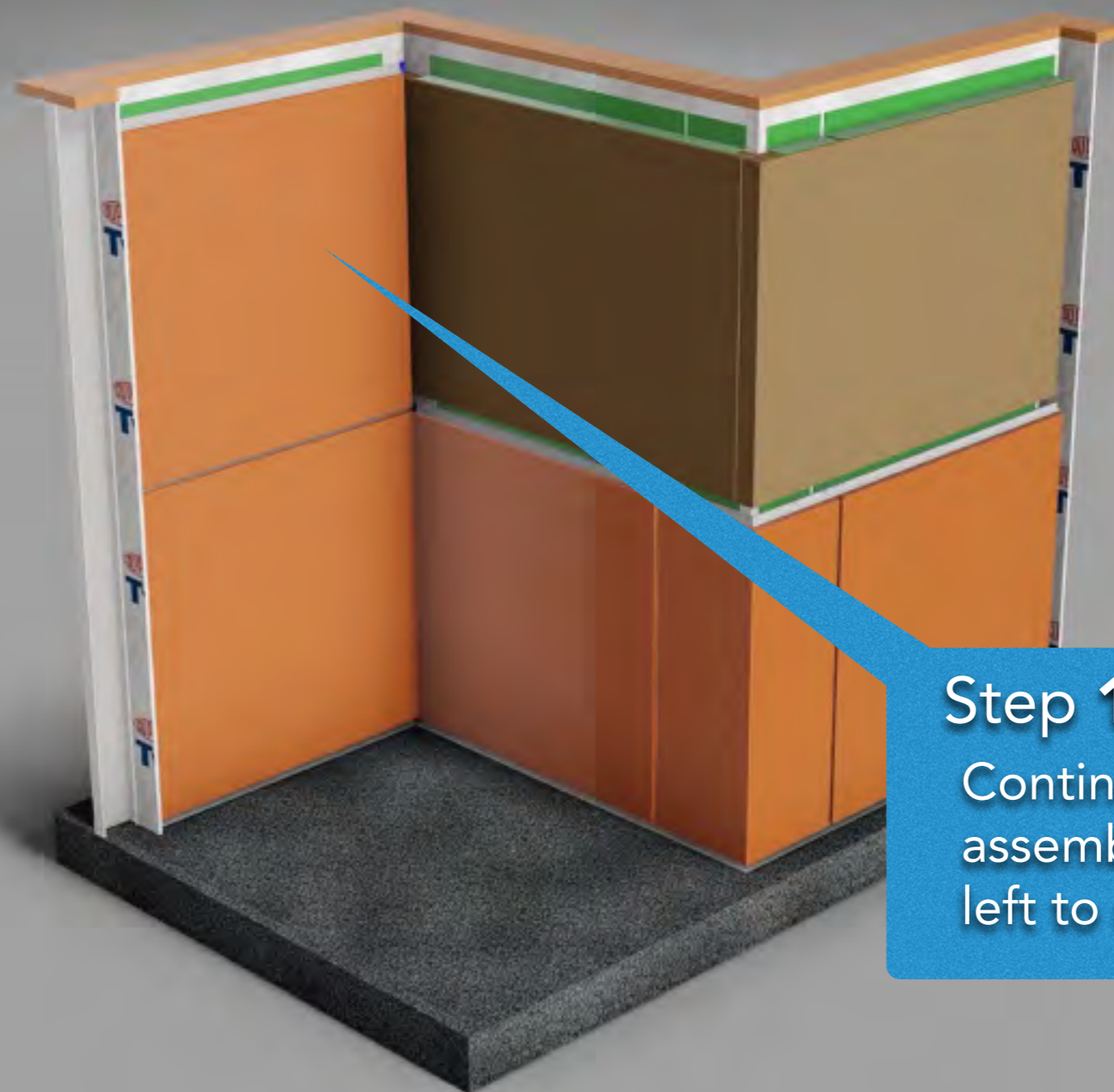

Step 10

Continue to install panel assemblies, working from left to right.

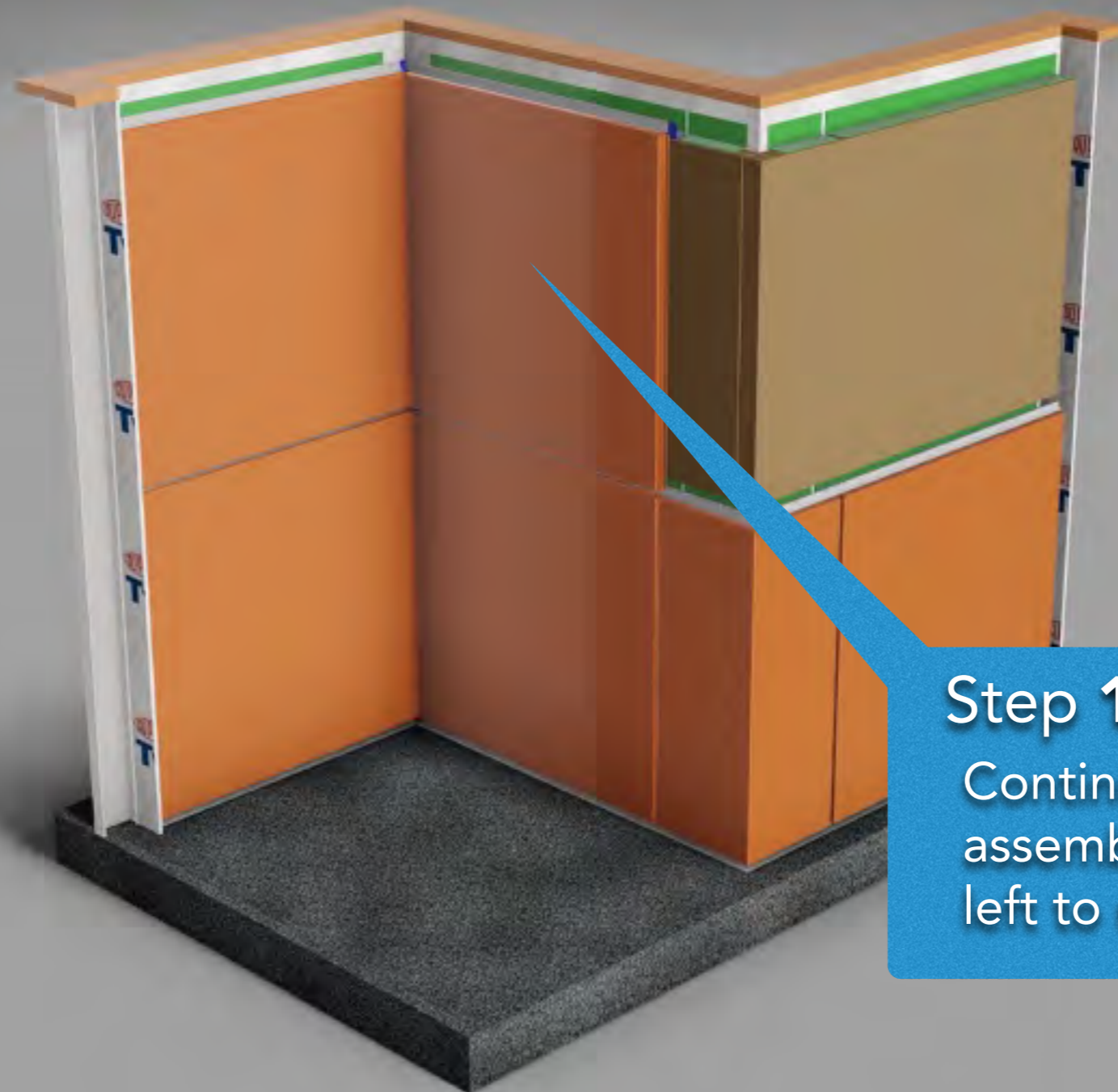

Step 10

Continue to install panel assemblies, working from left to right.

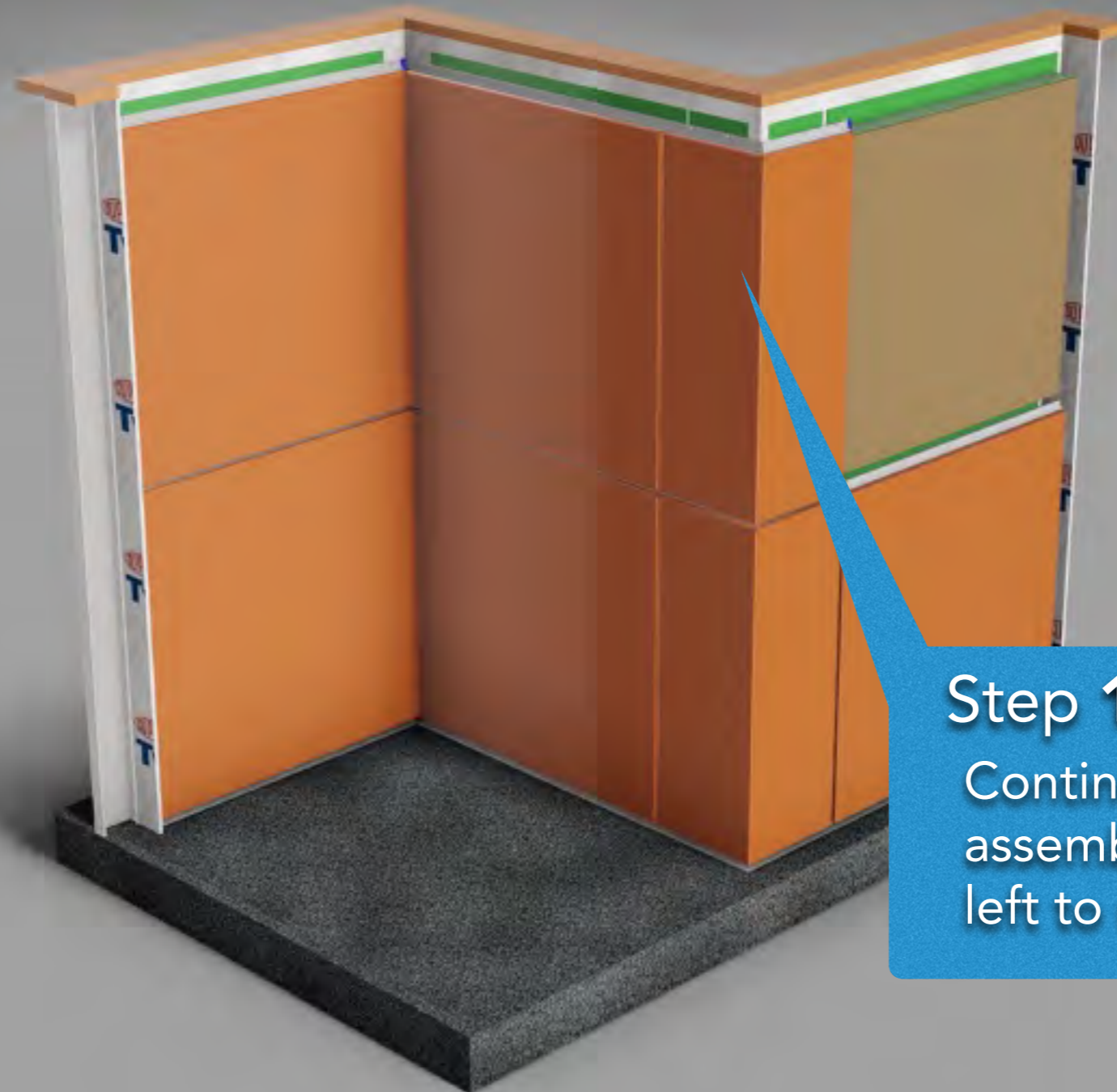

Step 10

Continue to install panel assemblies, working from left to right.

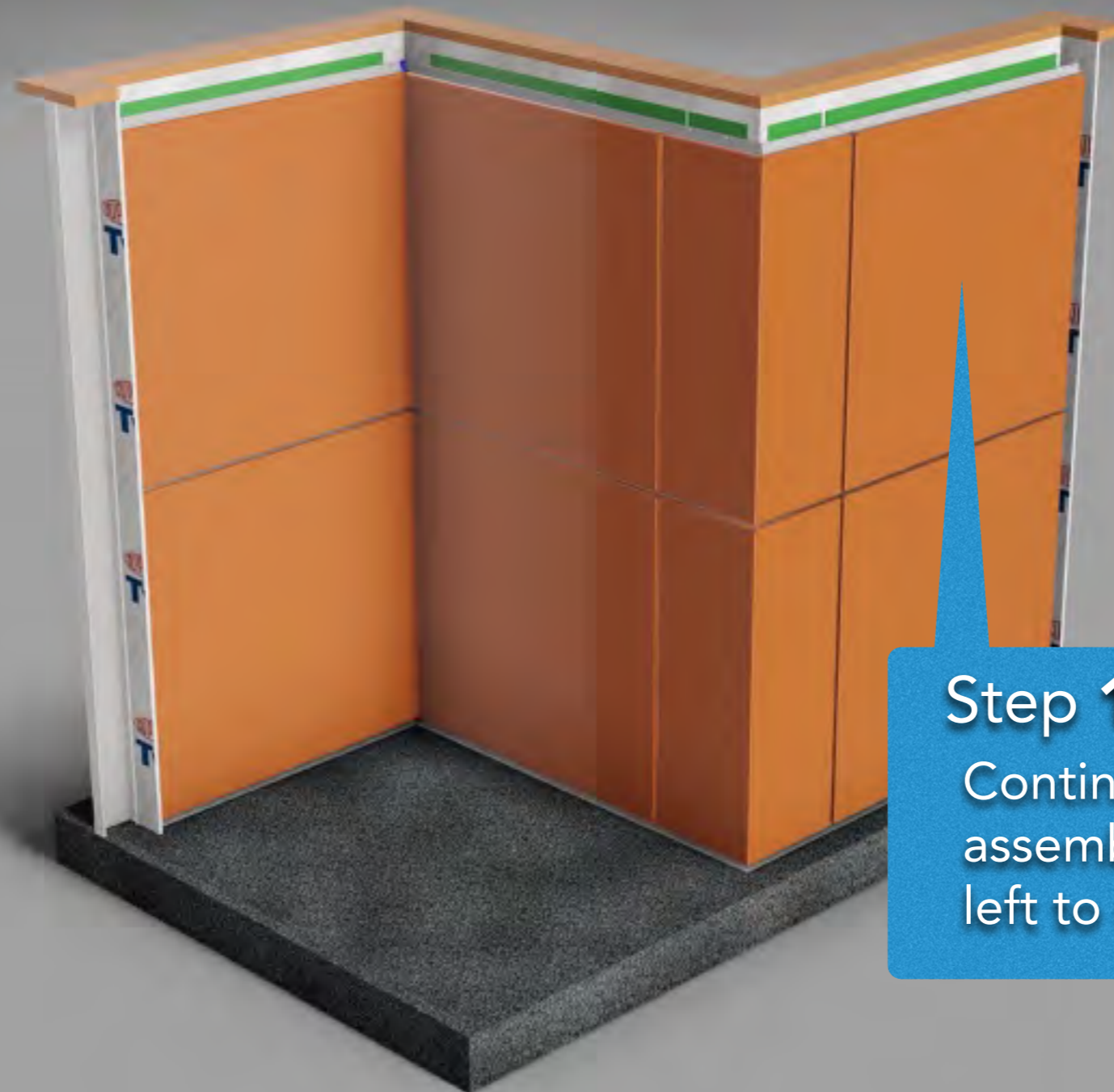

Step 10

Continue to install panel assemblies, working from left to right.

The panels reach the top of the wall. Now it's time to install the flashing.

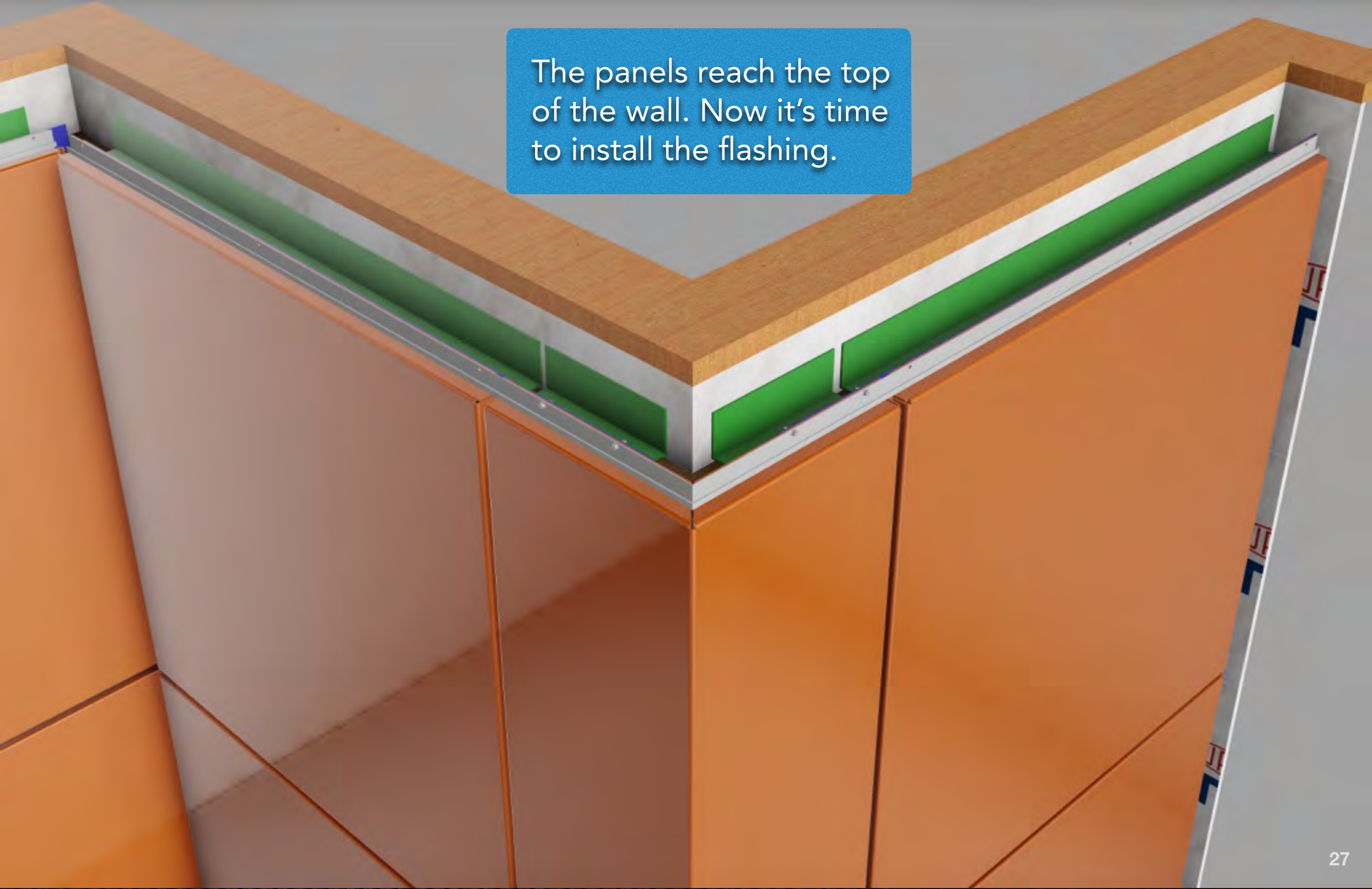

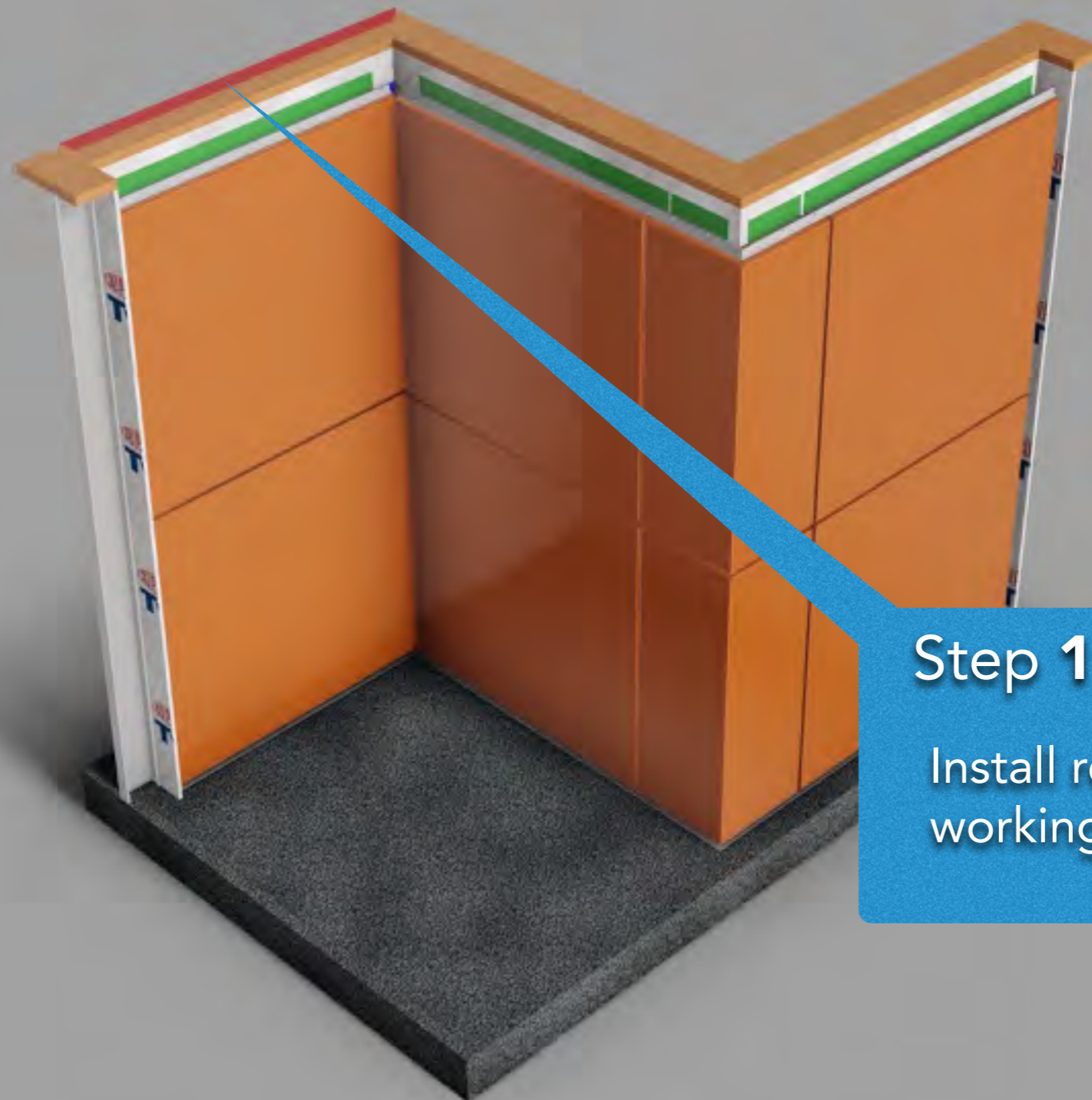

Step 11

Install rear flashing,
working from left to right.

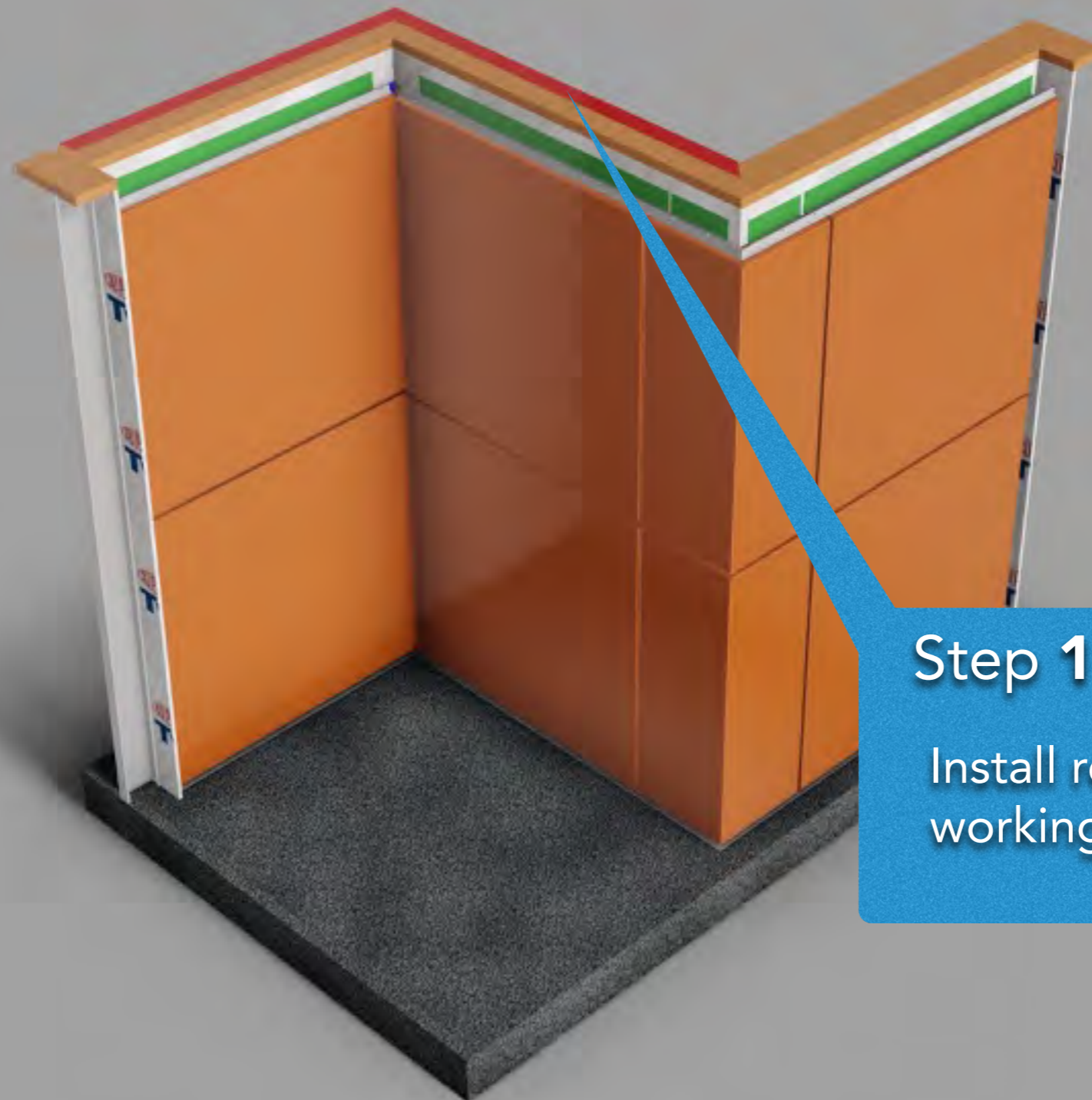

Step 11

Install rear flashing,
working from left to right.

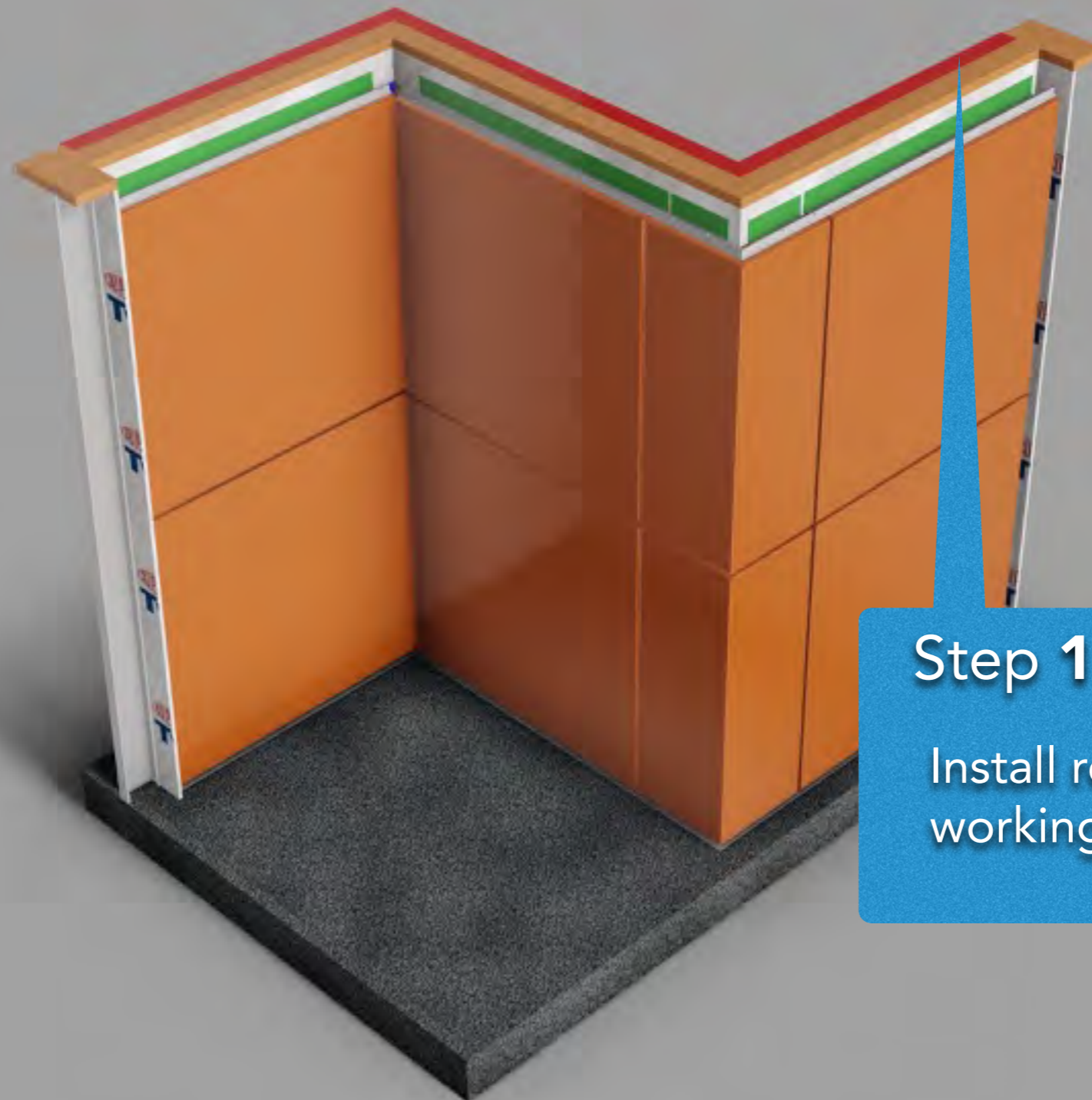

Step 11

Install rear flashing,
working from left to right.

Step 12

Install coping angle mounts,
working from left to right.

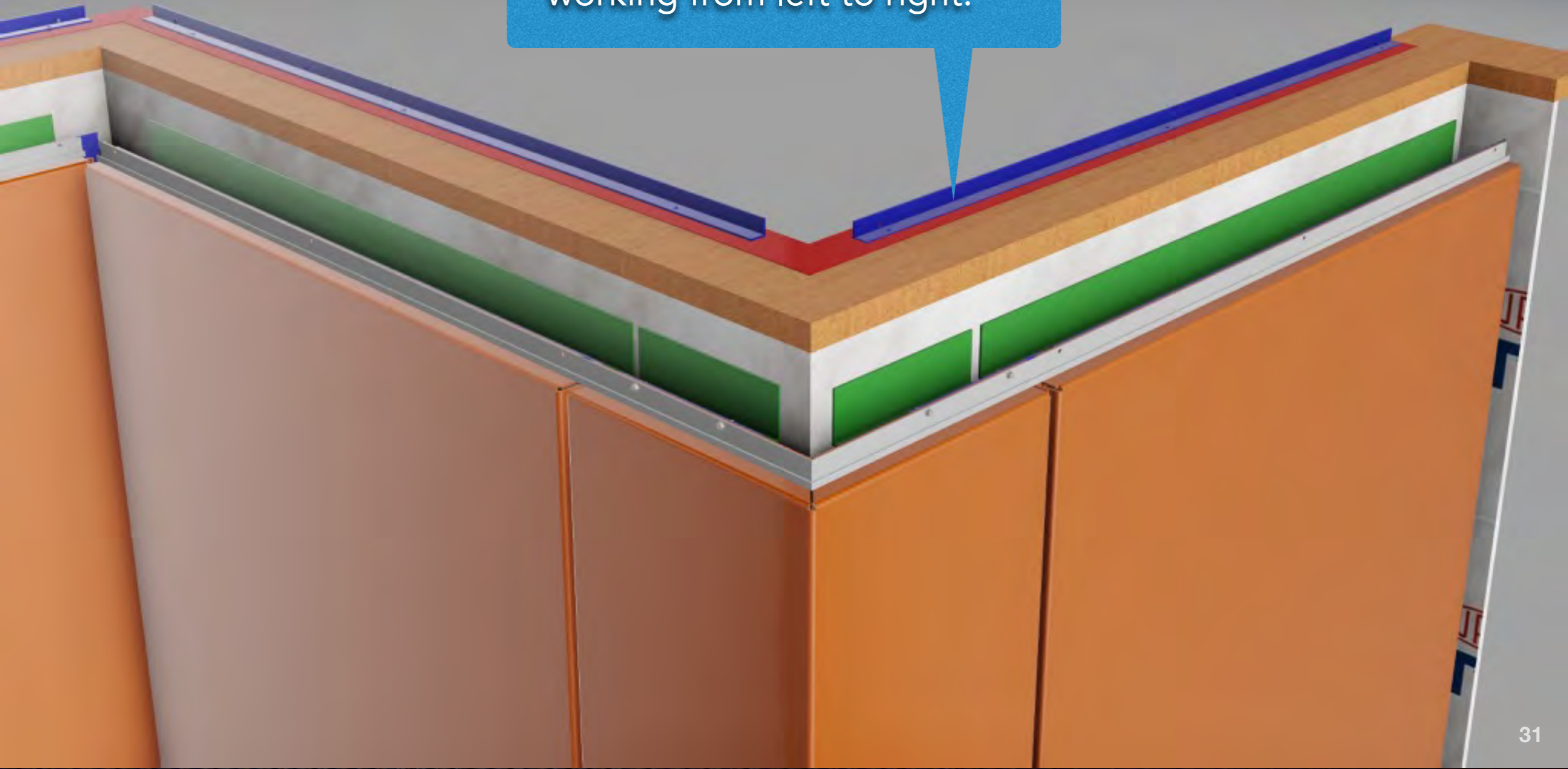

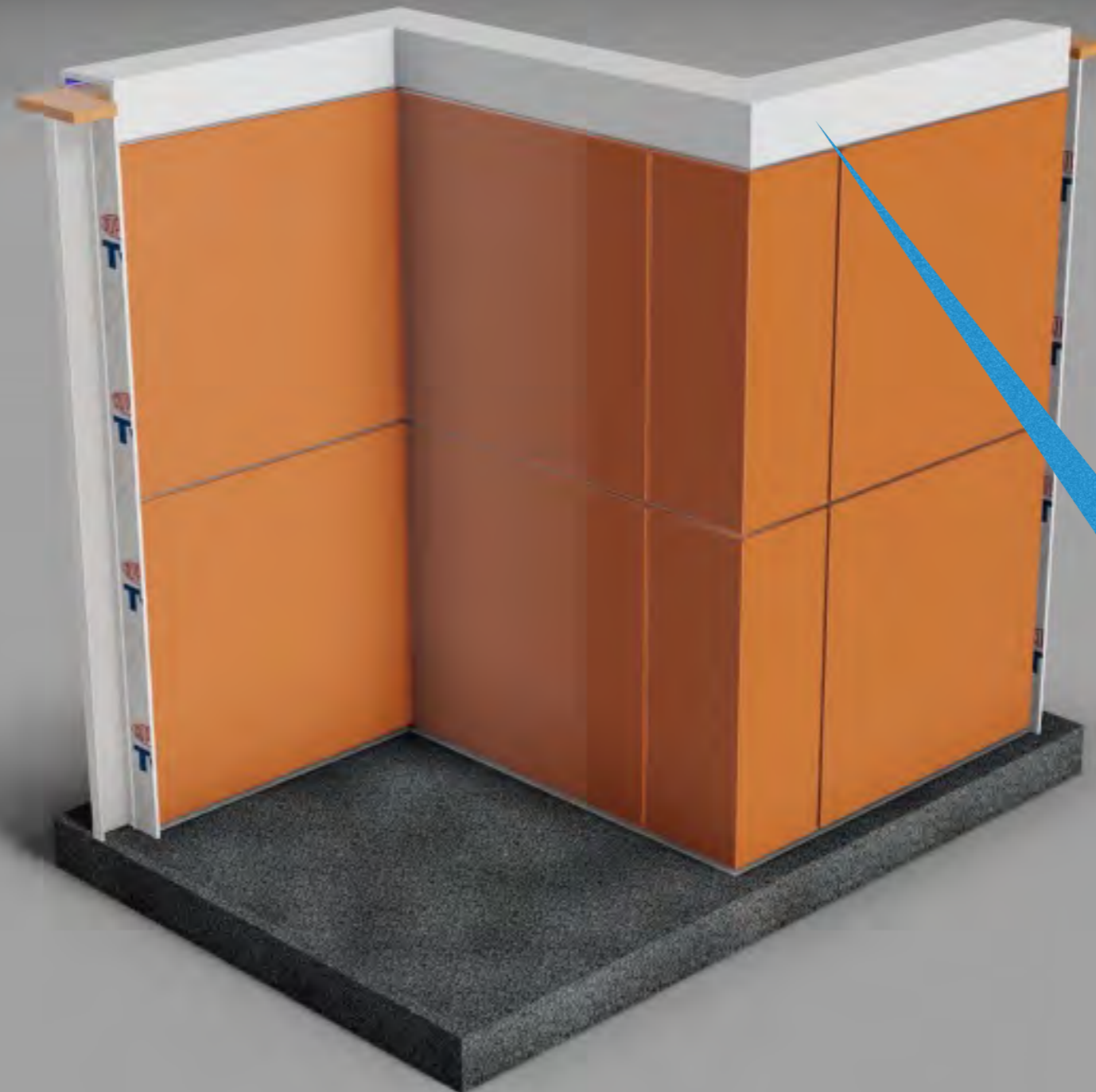

Step 13
Install coping.